

### HALF MASK DOUBLE CARTRIDGE

Before using the half mask and the related filters, please carefully read and understand these instructions. The half masks meet the requirement of Regulation (EU) 2016/425 and are CE marked accordingly. They have also been tested according to EN 140:1998.

#### USER INSTRUCTIONS

1. This Half mask must be used with two filters to protect people from harmful working environments. The protection performance is dependant on the filters.
2. This half mask is compatible with the following combined filters:

MODEL	MARKING	CLASS	PROTECTION AGAINST	COLOUR CODING
RE-GFILTA1	A1	Class 1	A1 Filter - For use against organic gases and vapors with boiling point > 65°C (up to 1000 parts per million).	Brown
RE-GFILTB1	B1	Class 1	For use against inorganic gases and vapors.	Grey
RE-GFILTE1	E1	Class 1	For use against sulphur dioxide and other acidic gases and vapours.	Yellow
RE-GFILTK1	K1	Class 1	For use against ammonia and organic ammonia derivatives.	Green
RE-GFILT-ABEK1	ABEK1	Class 1	For use against certain organic gases and vapours, certain inorganic gases and vapours, sulfur dioxide and other acidic gases and vapours, ammonia and organic ammonia derivatives.	

3. Leave the contaminated area immediately and replace respirator if:

- The half mask becomes damaged;
- You taste or smell contaminants or an irritation occurs;
- Breathing becomes difficult;
- Dizziness or other distress occurs.

4. Failure to follow all instructions and limitations and failure to wear this respirator during exposure at all times can reduce respirator protection effectiveness and may result in sickness or death.

#### WARNING

1. The half mask does not supply oxygen. Please do not use in atmospheres containing less than 19.5% oxygen.
2. Do not use this half mask in oxygen enriched air.
3. Ensure that the mask fits tightly over your mouth and nose, to ensure an air-tight fit.
4. It is unlikely that the requirements for a proper seal will be achieved if the user has facial hair.
5. If you cannot achieve a proper fit, do not enter the contaminated area.
6. The half mask must be used with two filters.
7. The half mask must be used with general air quality.
8. Stay away from the contaminated areas when replacing the filters.
9. Do not use these masks in direct contact with open flames or liquid metal droplets. Use a heat resistant visor over the half mask.

#### INSPECTION PROCEDURE

Inspect the half mask before use to ensure that it is in good operating condition. It should be replaced if you observe damaged or defective parts.

The following inspection procedure is suggested:

1. Check the half mask for any cracks, tears and/or dirt.
2. Make sure that the head straps are intact and have good elasticity.
3. Examine all plastic and rubber parts for signs of cracking or fatiguing.
4. Check to ensure breathing is smooth and there is no leaking.
5. Examine to ensure that filters comply with the working environment.

#### CLEANING AND STORAGE INSTRUCTIONS

1. Cleaning is recommended after use. Remove the filters before cleaning.
2. Clean the face piece with medical grade alcohol, and let dry in room temperature.
3. The cleaned respirator should be stored away in its original packaging or in a container away from contaminated areas when not in use. Always remember to store away from direct daylight or any source of heat.

#### FITTING INSTRUCTIONS

1. This half mask is a double filtering device. Please assemble the two filters before wearing (Fig.1).
2. Loosen the head harness. Hold the half mask in the position over nose and mouth (Fig.2).
3. Place the superior head harness on the top of the skull. If necessary, readjust the head harness (Fig.3).
4. Release the inferior head harness and place it on neck, then pull the head harness to proper position to get a good seal (Fig.4).
5. Press the palm of your hand over the exhalation valve cover and exhale gently. If no air leaks are being noticed between face and mask a proper fit has been achieved. If a leak has been detected reposition the respirator and readjust the tension of the head harness to eliminate leakage. Repeat the fit check (Fig.5).

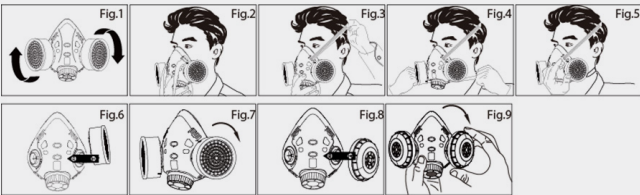

#### MAINTENANCE

Use only original spare parts. After use the half mask must be checked and cleaned. Replace damaged parts. Head Harness to be replaced every 6 months and to be cleaned frequently. Valves to be replaced every 12 months. When stored as stated, the expected shelf life of the product is 5 years from date of manufacture.

### GAS FILTER

Before using the gas filter, please carefully read and understand these instructions. The gas filters are in compliance with PPE Regulation (EU) 2016/425 and Harmonized standard EN 14387:2004+A1:2008. **Supplied separately.**

#### WARNING

1. This gas filter does not produce oxygen. It is for use in normal breathing air quality. Do not use in areas of oxygen deficiency or oxygen enriched air.
2. Do not use in explosive atmosphere.
3. Storage under conditions other than those specified by the manufacturer may affect the shelf life.
4. Follow guidance as to use of filters with both full face mask or half mask.

#### USE LIMITATIONS

This cartridge must never be used under the following conditions:

1. Oxygen concentration is lower than 19.5%.
2. Where there is in an oxygen-enriched environment where oxygen concentration >23.5%.
3. Where the type of poison gas is unknown. The gas filter must only be used according to the type and classification on the marking.
4. For specific applications contact your Health & Safety representative.

#### USER INSTRUCTIONS

1. Check gas filter and package prior to use. Ensure the gas filter is in good condition. Do not use if there are holes, deformations or cracks on the filter.
2. The gas filter can only be used according to its type and class. See marking on the gas filter before use. Choose the appropriate filter to use. (Refer Markings and applications).

3. The gas filter must be replaced if the user experiences increased breathing difficulty.
4. Leave the contaminated area when you replace the gas filter.
5. If you smell contaminants, or feel dizziness, headache, irritation or other discomfort, you should leave the dangerous area immediately and replace the gas filter.

#### FITTING INSTRUCTIONS

1. This gas filter is for a double filtering device. Please assemble two filters with the Rebel RE-HALMADBL mask before wearing. Remove filter from mask after use.
2. Align the gas filter with the mask connector base, and put them together. Turn the filter clockwise to stop (Fig.6).
3. Check that the gas filters have connected snugly with the half mask.
4. Turn the filter anticlockwise for removing the gas filter (Fig.7).

#### MAINTENANCE

The Gas filter is not re-usable. It does not need cleaning or maintenance.

#### STORAGE CONDITIONS

Store under conditions specified by the manufacturer, otherwise it may affect its classification and shelf life. Gas filter shall be stored in a dry, clean, low humidity environment. Do not use out of shelf life. Store between temperatures of -10 and +30 deg Centigrade, and where relative humidity is < 70%. The expiry date of the filter is clearly marked on the label.

#### MARKINGS AND APPLICATIONS

MODEL	MARKING	CLASS	PROTECTION AGAINST	COLOUR CODING
RE-GFILTA1	A1	Class 1	A1 Filter - For use against organic gases and vapours with boiling point > 65°C (up to 1000 parts per million).	Brown
RE-GFILTB1	B1	Class 1	For use against inorganic gases and vapours.	Grey

RE-GFILTE1	E1	Class 1	For use against sulphur dioxide and other acidic gases and vapours.	Yellow
RE-GFILTK1	K1	Class 1	For use against ammonia and organic ammonia derivatives.	Green
RE-GFILT-ABEK1	ABEK1	Class 1	For use against certain organic gases and vapours, certain inorganic gases and vapours, sulfur dioxide and other acidic gases and vapours, ammonia and organic ammonia derivatives.	

Organic gases are characterised by having the presence of Carbon atoms in them. Inorganic gases do not have Carbon atoms (although some exceptions do exist). Please consult your Health & Safety representative if you are unsure as to the correct cartridge to use.

Class 1 indicates that the filters have a low capacity – ie they are not suitable for extreme concentrations of gases or vapours.

The Rebel gas filter is to be used in conjunction with the Rebel Half Mask. If either product is used with another brand, we cannot be held responsible for the efficacy of the product.

**PARTICLE PRE FILTER**  
Before using the particle filter, please carefully read and understand these instructions. The particle filters are in compliance with PPE Regulation (EU) 2016/425 and Harmonized standard EN 143:2000+A1:2006. **Supplied separately.**

**WARNING**  
1. This particle filter does not produce oxygen. It is for use in normal breathing air quality. Do not use in areas of oxygen deficiency or oxygen enriched air.

2. Do not use in explosive atmosphere.
3. Storage under conditions other than those specified by the manufacturer may affect the shelf life.
4. Follow guidance as to use of filters with both full face mask or half mask.

**USE LIMITATIONS**  
This cartridge must never be used under the following conditions:  
1. Oxygen concentration is lower than 19.5%.  
2. Where there is in an oxygen-enriched environment where oxygen concentration >23.5%.  
3. Where the type of poison gas is unknown. The gas filter must only be used according to the type and classification on the marking.  
4. For specific applications contact your Health & Safety representative.

**USER INSTRUCTIONS**  
Particle filters are used to protect against solid or liquid substance in a fine particulate state. Air enters the particle filter and passes through to the user after the fine particles have been removed.

- Some particle filters have their own casings, and can be used by themselves if there are no noxious or irritant gases present.
- Some particle filters are built into gas filters, so that both fine particles as well as noxious / irritant gases are removed.
- Some particle filters come with a retainer casing, which fits on top of the gas filter. This particle filter cannot be used by itself – it needs to be used in conjunction with a gas filter.

1. Check particle filter and package prior to use. Ensure the particle filter is in good condition. Do not use if there are holes or deformations on the filter, or if it is dirty or shows signs of being used before.
2. The particle filter can only be used according to its type and class. See marking on the gas filter before use. Choose the appropriate filter to use. (Refer Markings and applications).
3. The particle filter must be replaced if the user experiences increased breathing difficulty.
4. Leave the contaminated area when you replace the gas filter.

5. If you smell contaminants or feel dizziness, headache, irritation or any other discomfort, you should leave the dangerous area immediately and add a gas filter to the particle filter.

**FITTING INSTRUCTIONS**  
NOTE: If the particle filter is already built into the gas filter, then no additional fitting instructions are required – just fit the filter as per the gas filter instructions. If the particle filter is in its own casing, then follow the instructions below:  
1. Align the particle filter with the mask connector base, and put them together. Turn the filter clockwise to stop (Fig.8).  
2. Turn the filter anticlockwise for removing the particle filter (Fig.9).  
If the particle filter is accompanied by a retainer, then fit the gas filter first (using the instructions shown above). Place the particle filter over the open vents of the gas filter, and then fit the filter retainer over the filter, and click it onto the gas filter. Ensure that the retainer (with the particle filter inside) fits snugly onto the gas filter. This prefilter is to be used in conjunction with the Rebel Gas Filter. If it is used with another brand of gas filter, then we cannot be responsible for its efficacy.

**MAINTENANCE**  
The Particle filter is re-usable, until the user starts to have difficulty breathing. After that, it must be replaced. Place it back in the original package while it is not being used. It does not need cleaning or maintenance.

**STORAGE CONDITIONS**  
Store under conditions specified by the manufacturer, otherwise it may affect its classification and shelf life. Particle filters shall be stored in a dry, clean, low humidity environment. Do not use out of shelf life. Store between temperatures of -10 and +30 deg Centigrade, and where relative humidity is < 70%. The expiry date of the filter is clearly marked on the label.

MODEL	MARKING	PROTECTION AGAINST	OEL (OCCUPATIONAL EXPOSURE LIMIT) / PROTECTION LEVEL
RE-PREFILTP2	P2R	Solid or liquid substances in a fine particulate state. Re-useable.	Protection level provided from dust particles is (< or =) 10 times the OEL limit.
RE-PREFILTP3	P3R	Solid or liquid substances in a fine particulate state. Re-useable.	Protection level provided from dust particles is (< or =) 50 times the OEL limit.

**Manufacturer**  
Rebel Safety Gear (Pty) Ltd  
PO Box 8804, Edenglen, 1613, South Africa  
Cnr Mountjoy & George Allen St, Wilbart, Johannesburg, South Africa  
www.rebelsafetygear.com

**Certification body**  
CCQS Certification Services Limited  
Block 1 Blanchardstown Corporate Park, Ballycoolin Road, Blanchardstown, Dublin 15 D15 AKK1, Dublin (NB2834)

